

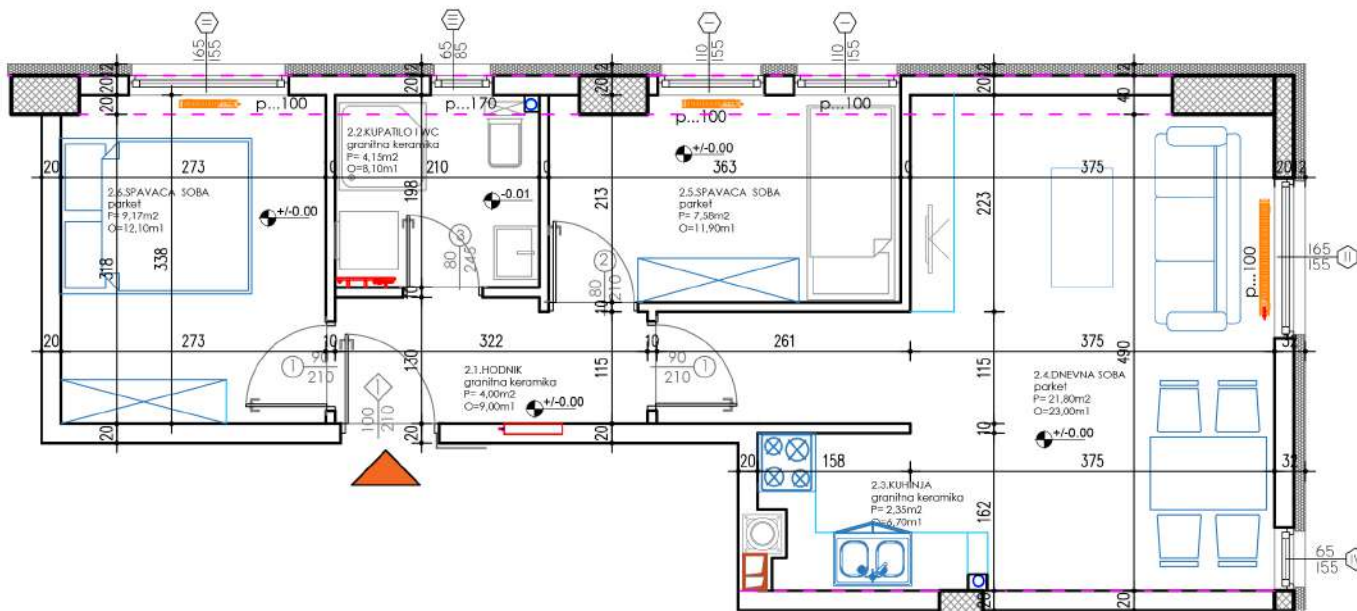

STAN BR. 2

P= 49,05 m²



STAN 2

1.	HODNIK	4,00 m ²
2.	KUPATILO	4,15 m ²
3.	KUHINJA	2,35 m ²
4.	DNEVNA SOBA	21,80 m ²
5.	SPAVAĆA SOBA	7,58 m ²
6.	SPAVAĆA SOBA	9,17 m ²
UKUPNO		49,05 m²



